

# Walk through 4 Order

## Problem Statement

There is a need for a walkway  
around the west side of  
the building. The walkway  
is 10 ft wide.

## Concept Statement

Contemporary twist on  
nature.

# OUTDOOR LOUNGE SITE ANALYSIS

Legend

○	Plant
□	Shrubs
◻	Drain
—	Water Gas Line
•	tree
▨	Bark
○	sprinkler
—	circumference
◻	Large Shrubs
△	bubble

Corey  
Crisson

20

CONCRETE  
WALKWAY

300 BUILDING

ENTRANCE

300 BUILDING

on site

- |    |            |
|----|------------|
| 1  | Drain      |
| 1  | Gas Line   |
| 1  | Water Line |
| 2  | Trees      |
| 18 | sprinklers |
| 22 | shrubs     |
| 4  | PLANTS     |
|    | Bark       |

## NOTES

- People are walking through the site. so we need a walk way through the site.
- Shrubs and Bark needs to go
- trees stay
- Plants should stay for beauty.

## IDEAS

- Lunch area Lounge.
- Student hang out
- Gardens out Door Lounge
- Lunch area with Gardens

# FORMAL GARDEN / OUT DOOR LOUNGE. SITE ANALYSIS

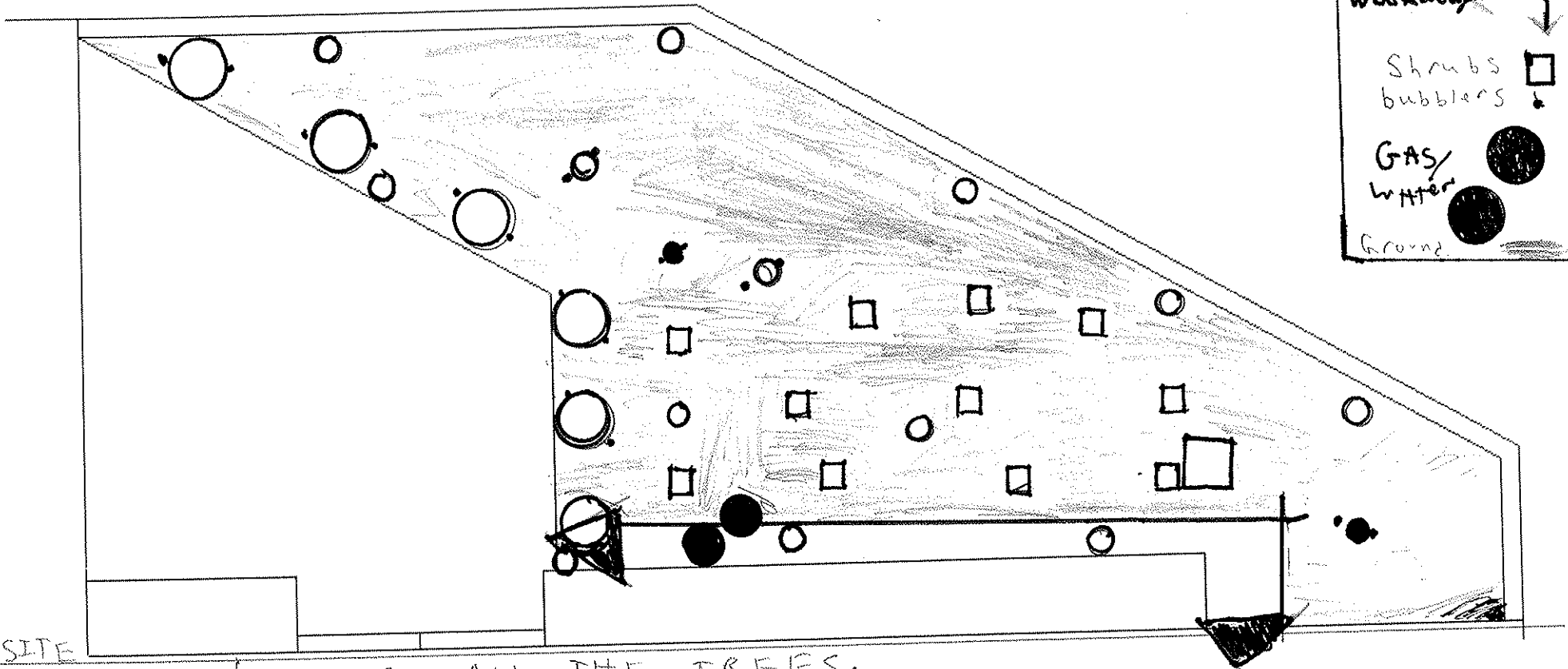
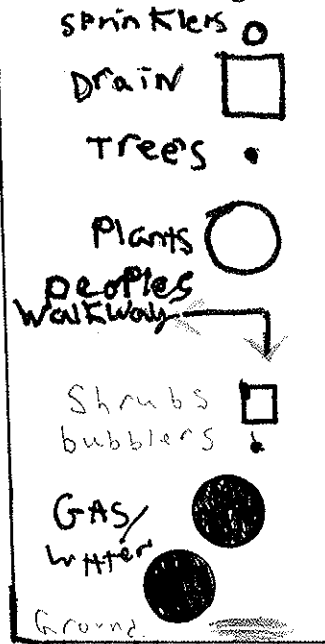

## ON SITE



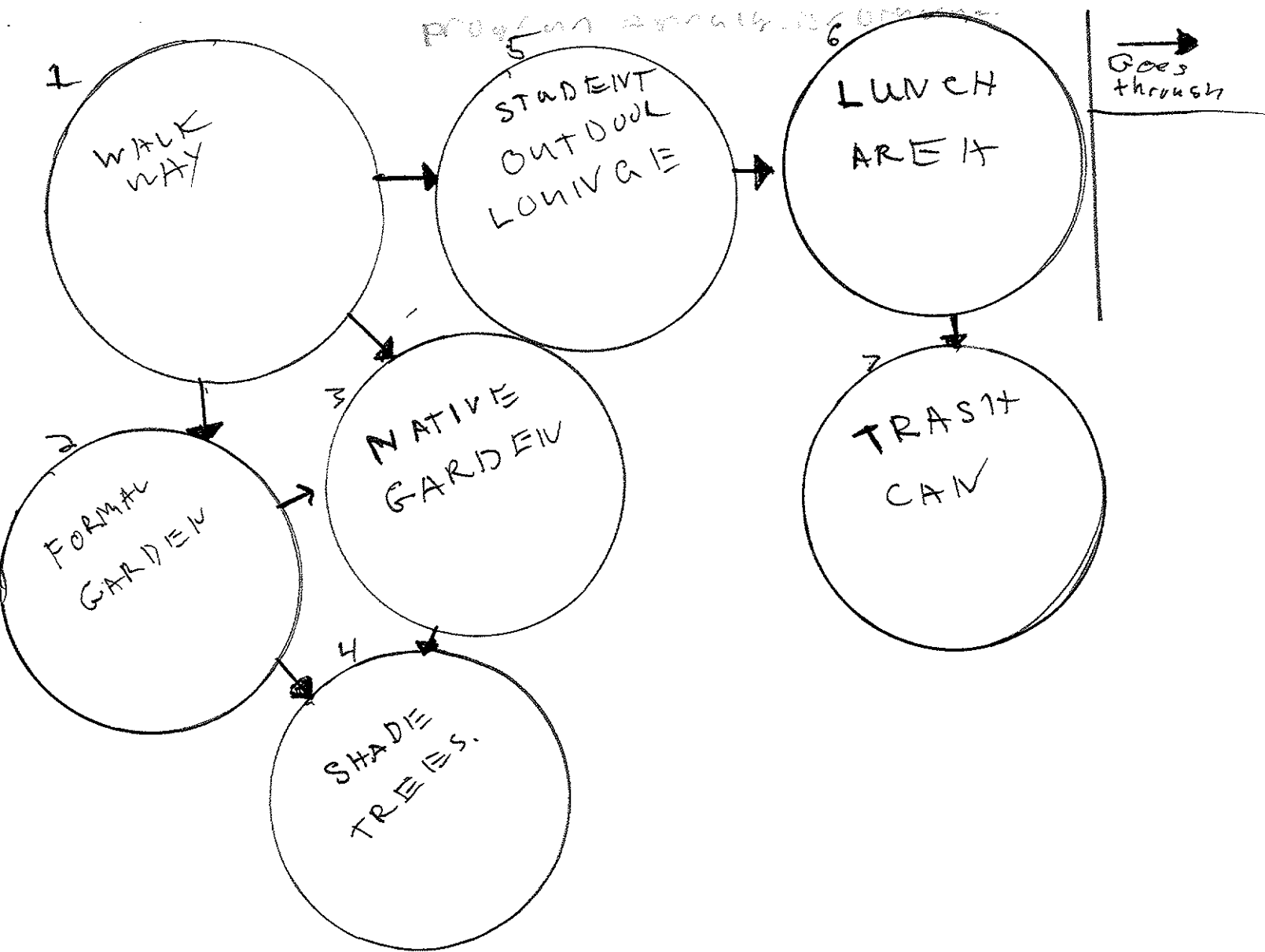

- 1 DRAIN
- 1 GAS LINE
- 1 WATER LINE
- 2 TREES
- 13 SPRINKLERS
- 20 SHRUBS
- 4 PLANTS
- 16 bubblers
- BARK

- KEEP ALL THE TREES.
- get rid of Plants and shrubs
- Get rid of all ground cover.
- put in walkway
- be careful while removing sprinklers.
- Keep the four bubblers on Trees.

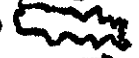

PROS	CONS
1 WALK through the site.	1 Can crowd easily.
2 Likes a professional look	2 People could ruin it.
3 Keeps a local look	3 running out of space.
4 Provides shade	4 people could climb trees
5 Keep kids out of trouble	5 Kids could destroy it.
6 Kids can eat lunch	6 Kids could trash it.
7 Kids won't trash it.	7 more work for maintenance and kids could knock it over.

# CONCEPTUAL PLAN

- LEGEND
- FORMAL GARDEN 
  - ANNULATED BED 
  - FOUNTAIN 
  - LOUNGE 
  - TREE 

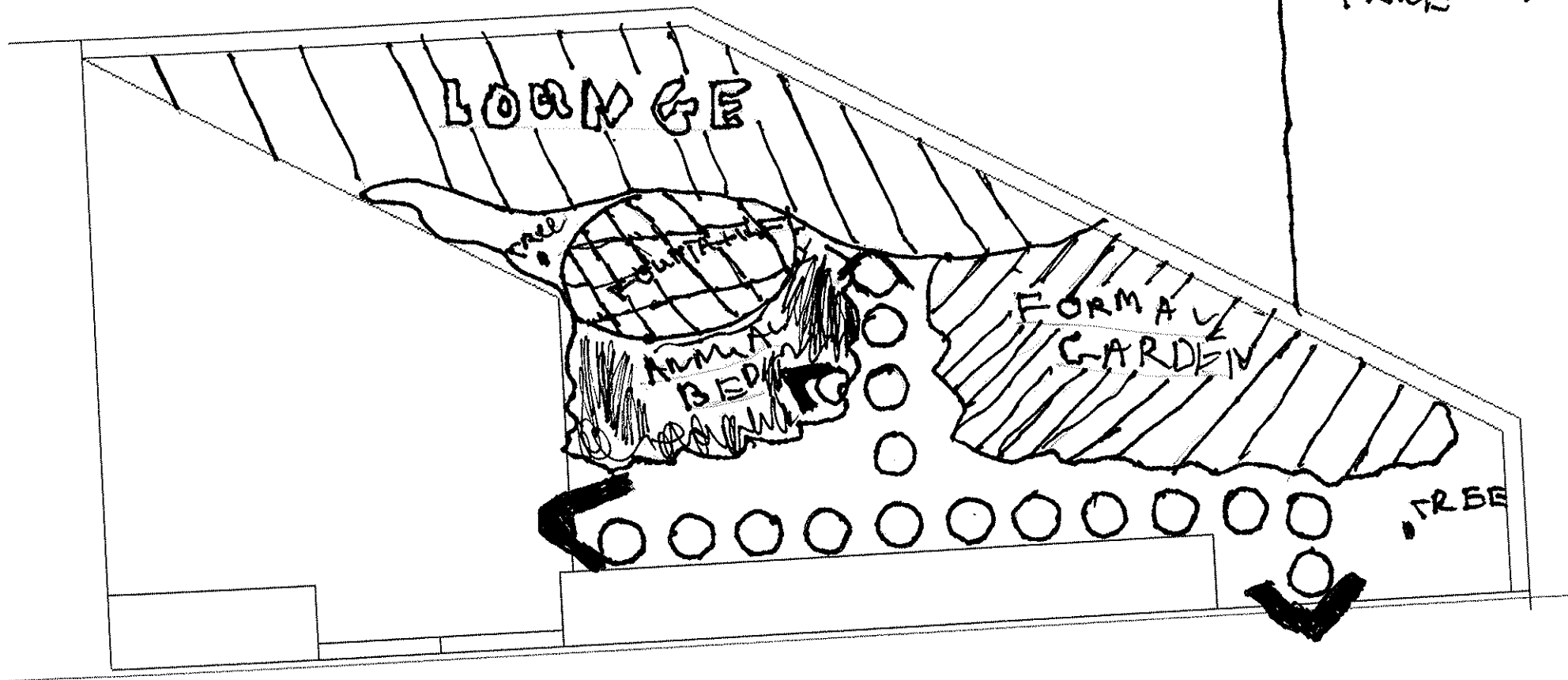

# CONCEPTUAL PLAN

